

### PROJECT NAME: AARYAN AMBIENCE

Fp. No. 188/2, Near Gota, S G Highway, Ahmedabad



Property Type:	Flat/Appartment
Builder Name:	Aarya Property
Locality:	Gota
City:	Ahmedabad
State:	Gujarat
Project Price (Onwards):	Price On Request
Availability:	01-12-2024
Project Type:	Ongoing
Sample House Ready:	No

Property Facilities:	CCTV Camera	Wash Room	Vastu Compliant
Building Amenities:	CCTV Camera Gym	Fire Safety	Lift

#### Project Data:

Flat Size :	615 - 767 sqft	Allocate Parking :	yes
-------------	----------------	--------------------	-----

#### PROJECT DETAILS

Sr. No.	Type	Constructed Area (SBA)	Area Unit
1	2 BHK	615	Sq. Ft.
2	3 BHK	767	Sq. Ft.

- Stamp duty, Registration charges, Legal charges, Auda, Electricity, Corporation, Parking and all other extra charges shall be borne by the purchaser.

- GST, TDS and any other taxes levied in future shall be borne by the purchaser.

## PROPERTY PHOTOS

---

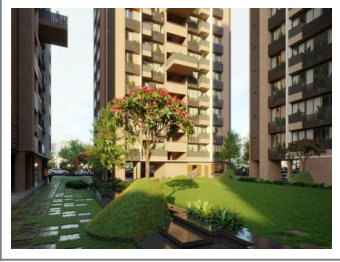

**Note :** All visuals, images, facilities and other details shown here are for presentation only and are subject to change by the builder/developer/owner without any obligation.

**Disclaimer :** [smartworld.com/](http://smartworld.com/) is an online Real Estate platform for Seller and Agent/Broker/Customer/Buyer to facilitate their real estate needs. P MART cannot control any transactions between the Seller and the Agent/Broker/Customer/Buyer. Properties details displayed on the [smartworld.com/](http://smartworld.com/) website are for informational purposes only. Information regarding real estate projects including property/project details, by various Builder(s)/Developer(s)/Broker(s) who have advertised their property/project. Nothing contained herein shall be deemed to constitute legal advice, solicitations, marketing, offer for sale, invitation to offer, invitation to acquire by the developer/builder or any other entity. P MART shall neither be responsible nor liable to mediate or resolve any disputes or disagreements between the Seller and Agent/Broker/Customer/Buyer. Hereby we strongly advised to visit the relevant RERA website before taking any decision based on the contents displayed on the website.