

PROJECT NAME: KAVERI SOHAM VISTARA

Near Shilaj Over Bridge, S.p. Ring Road



Property Type:	Flat/Appartment
Builder Name:	A. Shridhar
Locality:	Shilaj
City:	Ahmedabad
State:	Gujarat
Availability:	31-12-2021
Project Type:	Ongoing
Sample House Ready:	No

Rera ID: PR/GJ/AHMEDABAD/AHMEDABAD CITY/AUDA/MAA04832/130219

Description: 3 B H K Apartments

Architect Name: Sourabh Ajay Verma

Property Facilities: Door Bell Gas Connection

Building Amenities:	CCTV Camera	Garden	Fire Safety
	Visitor Parking	Lift	Gym
	Intercom	Power Backup	Security
	Piped Gas	Club House	House Keeping
	Borewell	Kid's Play Area	Wash Room
	Games Room	Waste Disposal	Terrace Garden
	Multi Purpose Court	Senior Citizen Area	Solar Panel
	Gated Community		

Specification:

Structure :	Earthquake resistant Safe & sound RCC frame structure
Interior Walls :	Internal : Putty Finish
Flooring :	2x2 tile flooring
Electrical :	Concealed wiring with ISI material and switches of branded make (anchor, roma or equivalent) 100% power back up for common services
Toilet :	2x1 wall and floor tiling Branded bath and sanitary fittings (Jaguar, cera or equivalent)
Sanitary Ware :	High Quality Sanitaryware and Accessories
Security Camera :	CCTV surveillance system Round the clock security personnel
Elevator :	2 elevators per block (incl. one stretcher elevator)
Doors & Windows :	Aluminum windows with powder coating Solid wood flush doors
A.c. :	AC piping and necessary provision for easy installation in drawing as well as all bedrooms
Plumbing :	Premium Quality Plumbing Fittings and Accessories.

PROJECT DETAILS

Sr. No.	Type	Constructed Area (SBA)	Area Unit	Parking
1	3 BHK	1550 Sq.Ft Super Builtup	Sq. Ft.	2
2	Shop	435 - 2674 Sq.Ft Super Builtup		1

- Stamp duty, Registration charges, Legal charges, Auda, Electricity, Corporation, Parking and all other extra charges shall be borne by the purchaser.

- GST, TDS and any other taxes levied in future shall be borne by the purchaser.

PROPERTY PHOTOS

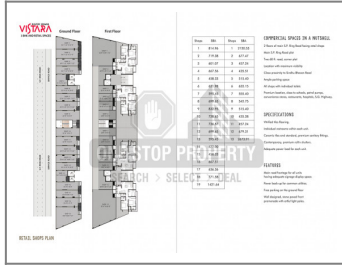
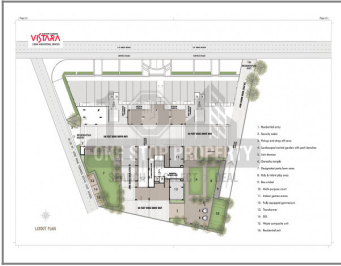
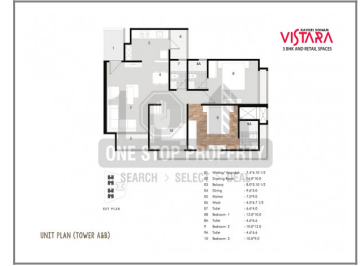

Note : All visuals, images, facilities and other details shown here are for presentation only and are subject to change by the builder/developer/owner without any obligation.

Disclaimer : smartworld.com/ is a online Real Estate platform for Seller and Agent/Broker/Customer/Buyer to facilitate their real estate needs. P MART cannot control any transactions between the Seller and the Agent/Broker/Customer/Buyer. Properties details displayed on the smartworld.com/ website are for informational purposes only. Information regarding real estate projects including property/project details, by various Builder(s)/Developer(s)/Broker(s) who have advertised their property/project. Nothing contained herein shall be deemed to constitute legal advice, solicitations, marketing, offer for sale, invitation to offer, invitation to acquire by the developer/builder or any other entity. P MART shall neither be responsible nor liable to mediate or resolve any disputes or disagreements between the Seller and Agent/Broker/Customer/Buyer. Hereby we strongly advised to visit the relevant RERA website before taking any decision based on the contents displayed on the website.