

### PROJECT NAME: ANANTARA IMPERIAL

Shilaj Circle To Science City Circle



Property Type:	Flat/Appartment
Builder Name:	A. Shridhar
Locality:	Science City
City:	Ahmedabad
State:	Gujarat
Availability:	01-06-2025
Project Type:	Ongoing
Sample House Ready:	No

#### Property Facilities:

Vastu Compliant

Servant Room

#### Building Amenities:

CCTV Camera

Garden

Fire Safety

Visitor Parking

Lift

Power Backup

Security

House Keeping

Borewell

Waste Disposal

Vastu Compliant

Boom Barrier

Entrance Foyer

Gated Community

#### Project Data:

Total No. of Tower :	1	No. Flats in Tower :	84
No. Floor in Tower :	22	No. of Flats per Floor :	4
Flat Size :	2802 - 6828 Sq.Ft. Super Builtup	Allocate Parking :	yes

### PROJECT DETAILS

Sr. No.	Type	Constructed Area (SBA)	Area Unit	Parking
1	3 BHK	2802 Sq.Ft. Super Builtup	Sq. Ft.	2
2	4 BHK	3595 Sq.Ft. Super Builtup	Sq. Ft.	3
3	Penthouse	5424 & 6828 Sq.Ft. Super Builtup	Sq. Ft.	4

---

- Stamp duty, Registration charges, Legal charges, Auda, Electricity, Corporation, Parking and all other extra charges shall be borne by the purchaser.

---

- GST, TDS and any other taxes levied in future shall be borne by the purchaser.

---

## PROPERTY PHOTOS

---

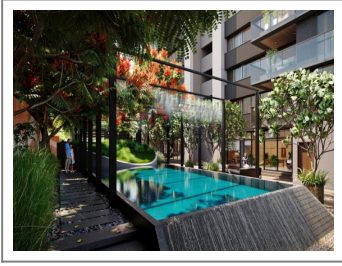

**Note :** All visuals, images, facilities and other details shown here are for presentation only and are subject to change by the builder/developer/owner without any obligation.

**Disclaimer :** pmartworld.com/ is a online Real Estate platform for Seller and Agent/Broker/Customer/Buyer to facilitate their real estate needs. P MART cannot control any transactions between the Seller and the Agent/Broker/Customer/Buyer. Properties details displayed on the pmartworld.com/ website are for informational purposes only. Information regarding real estate projects including property/project details, by various Builder(s)/Developer(s)/Broker(s) who have advertised their property/project. Nothing contained herein shall be deemed to constitute legal advice, solicitations, marketing, offer for sale, invitation to offer, invitation to acquire by the developer/builder or any other entity. P MART shall neither be responsible nor liable to mediate or resolve any disputes or disagreements between the Seller and Agent/Broker/Customer/Buyer. Hereby we strongly advised to visit the relevant RERA website before taking any decision based on the contents displayed on the website.