

PROJECT NAME: SHILP REVANTA

Near Club O7



| | |
|---------------------|-----------------|
| Property Type: | Flat/Appartment |
| Builder Name: | Shilp Group |
| Locality: | Shela |
| City: | Ahmedabad |
| State: | Gujarat |
| Availability: | 01-12-2024 |
| Project Type: | Ongoing |
| Sample House Ready: | Yes |

Rera ID: PR/GJ/AHMEDABAD/SANAND/AUDA/MAA07874/050121

Description: Premium 3 BHK Apartments & Shops.

Architect Name: DIPIKA CHAVDA Structure Consultant: P CUBE CONSULTANT

Property Facilities: Wash Room Vastu Compliant

| | | | |
|---------------------|---------------------------|---------------------|---------------------|
| Building Amenities: | CCTV Camera | Garden | Fire Safety |
| | Visitor Parking | Lift | Gym |
| | Power Backup | Swimming Pool | Security |
| | Club House | Library | Theater |
| | Multi Purpose Hall | Cricket Court | House Keeping |
| | Borewell | Kid's Play Area | Yoga Room |
| | Tt & Billiard | Wash Room | Games Room |
| | Waste Disposal | Vastu Compliant | Sauna & Steam |
| | Boom Barrier | Jogging Track | Skating Ring |
| | Water Lilly Pond | Children's Pool | Multi Purpose Court |
| | Pick up and Drop off Zone | Senior Citizen Area | Entrance Foyer |
| | Gated Community | | |

Specification:

| | | | |
|----------------------|--|--------------------------|-----|
| Interior Walls : | Internal Smooth Finish Plaster With Double Coat Birla Putty. External Double Coat Sand Face Plaster Or Texture With Acrylic Paint. | | |
| Flooring : | Vitrified Tile Flooring In Entire Apartment. | | |
| Doors : | Main Door - Decorative Main Door With Wooden Frame. Internal Door - Flush Door With Enamel Paint. | | |
| Electrical : | ISI Modular Switches. ISI Wires. Distribution Board With MCB For Safety And Protection. | | |
| Kitchen : | Granite Platform With Stainless Steel Sink Along With Electrical Point For Water Purifier. Designer Glaze Tile Dedo Upto Lintel Level. | | |
| Wash Area : | 24 Hours water supply. | | |
| Doors & Windows : | Sliding Aluminium Window Section With Anodized Or Powder Coated. | | |
| Bathrooms : | Designer Ceramic Or Glaze Tile Upto Lintel Level. CP Fittings - Chrome Plated Branded Bathroom Fittings. | | |
| Total No. of Tower : | 13 | | |
| No. Floor in Tower : | 14 | No. of Flats per Floor : | 4 |
| Flat Size : | 1510 Sq.Ft. Super Builtup | Allocate Parking : | yes |

PROJECT DETAILS

| Sr. No. | Type | Constructed Area (SBA) | Area Unit |
|---------|-------|---------------------------|-----------|
| 1 | 3 BHK | 1510 Sq.Ft. Super Builtup | Sq. Ft. |
| 2 | Shop | 499 - 2105 Sq.Ft. | Sq. Ft. |

- Stamp duty, Registration charges, Legal charges, Auda, Electricity, Corporation, Parking and all other extra charges shall be borne by the purchaser.

- GST, TDS and any other taxes levied in future shall be borne by the purchaser.

PROPERTY PHOTOS

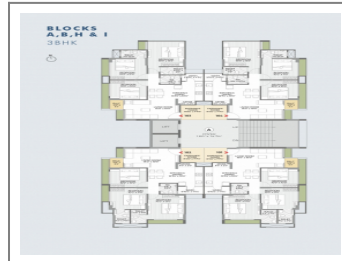
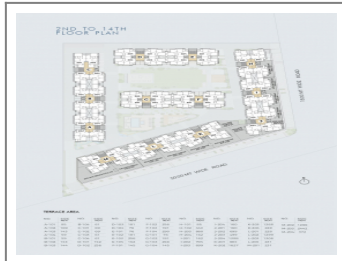
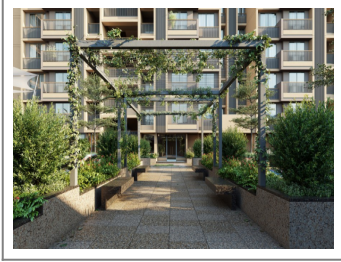

Note : All visuals, images, facilities and other details shown here are for presentation only and are subject to change by the builder/developer/owner without any obligation.

Disclaimer : smartworld.com/ is an online Real Estate platform for Seller and Agent/Broker/Customer/Buyer to facilitate their real estate needs. P MART cannot control any transactions between the Seller and the Agent/Broker/Customer/Buyer. Properties details displayed on the smartworld.com/ website are for informational purposes only. Information regarding real estate projects including property/project details, by various Builder(s)/Developer(s)/Broker(s) who have advertised their property/project. Nothing contained herein shall be deemed to constitute legal advice, solicitations, marketing, offer for sale, invitation to offer, invitation to acquire by the developer/builder or any other entity. P MART shall neither be responsible nor liable to mediate or resolve any disputes or disagreements between the Seller and Agent/Broker/Customer/Buyer. Hereby we strongly advised to visit the relevant RERA website before taking any decision based on the contents displayed on the website.