

PROJECT NAME: SWATI CHRYSANTHA

Club O7 Road, Off S.p Ring Road



Property Type:	Flat/Appartment
Builder Name:	Swati Procon
Locality:	Shela
City:	Ahmedabad
State:	Gujarat
Availability:	01-01-2021
Project Type:	Ongoing
Sample House Ready:	No

Rera ID: PR/GJ/AHMEDABAD/SANAND/AUDA/MAA01865/A1M/031219

Description: 3 B H K Apartments

Building Amenities:	CCTV Camera	Garden	Fire Safety
	Visitor Parking	Lift	Gym
	Intercom	Power Backup	Swimming Pool
	Security	Piped Gas	Club House
	Library	Multi Purpose Hall	Water Body
	Cricket Court	House Keeping	Borewell
	Outdoor Kitchen	Kid's Play Area	Games Room
	Waste Disposal	Tata Sky / Dth	Children's Pool
	Multi Purpose Court	Senior Citizen Area	Entrance Foyer
	Gated Community		

Specification:

Structure :	Earthquake resistant Safe & sound RCC frame structure
Interior Walls :	Internal : Putty Finish External : 100% Acrylic paint
Flooring :	Living / Dining / Bedrooms Vitrified Tiles Master Bedroom Wooden Flooring
Doors :	Main door : Natural Veneer Polished Others will be Flush Doors with Oil Paint
Electrical :	Concealed Copper Wiring With Modular Switches MCB Distribution Panel
Toilet :	Glazed / Ceramic Tiles up to Lintel Level Counter Basin / Wall Hung Basin EWC Couple Closet
Sanitary Ware :	CP BRASS Fittings : JAGUAR or equivalent
Security Camera :	24 X 7 Security Surveillance
Elevator :	Automatic high speed elevators
Kitchen :	Vitrified Tiles, Granite Platform with S.S. Sink
Doors & Windows :	Windows : Sliding Aluminium Windows
Plumbing :	Premium Quality Plumbing Fittings and Accessories.

PROJECT DETAILS

Sr. No.	Type	Constructed Area (SBA)	Area Unit
1	3 BHK	1436 Sq ft Super Builtup	Sq. Ft.

- Stamp duty, Registration charges, Legal charges, Auda, Electricity, Corporation, Parking and all other extra charges shall be borne by the purchaser.

- GST, TDS and any other taxes levied in future shall be borne by the purchaser.

PROPERTY PHOTOS

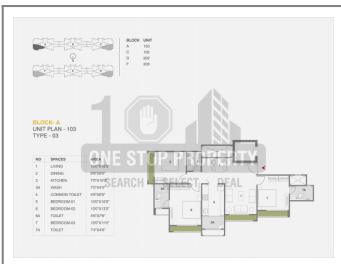
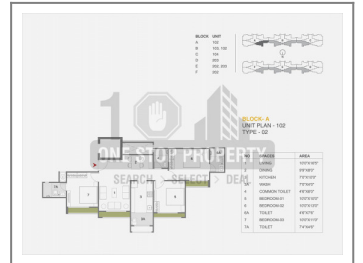
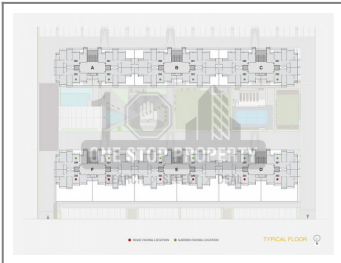
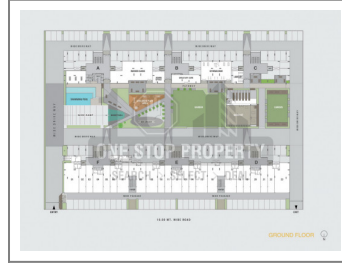

Note : All visuals, images, facilities and other details shown here are for presentation only and are subject to change by the builder/developer/owner without any obligation.

Disclaimer : smartworld.com/ is a online Real Estate platform for Seller and Agent/Broker/Customer/Buyer to facilitate their real estate needs. P MART cannot control any transactions between the Seller and the Agent/Broker/Customer/Buyer. Properties details displayed on the smartworld.com/ website are for informational purposes only. Information regarding real estate projects including property/project details, by various Builder(s)/Developer(s)/Broker(s) who have advertised their property/project. Nothing contained herein shall be deemed to constitute legal advice, solicitations, marketing, offer for sale, invitation to offer, invitation to acquire by the developer/builder or any other entity. P MART shall neither be responsible nor liable to mediate or resolve any disputes or disagreements between the Seller and Agent/Broker/Customer/Buyer. Hereby we strongly advised to visit the relevant RERA website before taking any decision based on the contents displayed on the website.